

CITY LIVING



76/17-25 Wentworth Avenue SYDNEY NSW

1 1 1

Situated near the corner of Oxford Street, this one-bedroom apartment offers residents not only the ultimate city lifestyle, but also pure convenience with all the amenities you could desire close by.

KEY FEATURES

The opportunity - With its desirable location, move in and make it your own, or purchase as an investment property for a lucky tenant

The locale - This part of the city delivers a plethora of activities for residents to enjoy, whether attending an event in Hyde Park, revelling in the buzz of the bars on Oxford Street, or shopping at the boutiques at Westfield; the

[For full version visit the website](https://www.cityliving.com.au)

Type : Apartment
Building Size : 7 sqm
View : <https://www.cityliving.com.au/sale/nsw/sydney-city/sydney/residential/apartment/7223379>



Tasman Fallshaw
02 8248 9104

<https://www.cityliving.com.au>

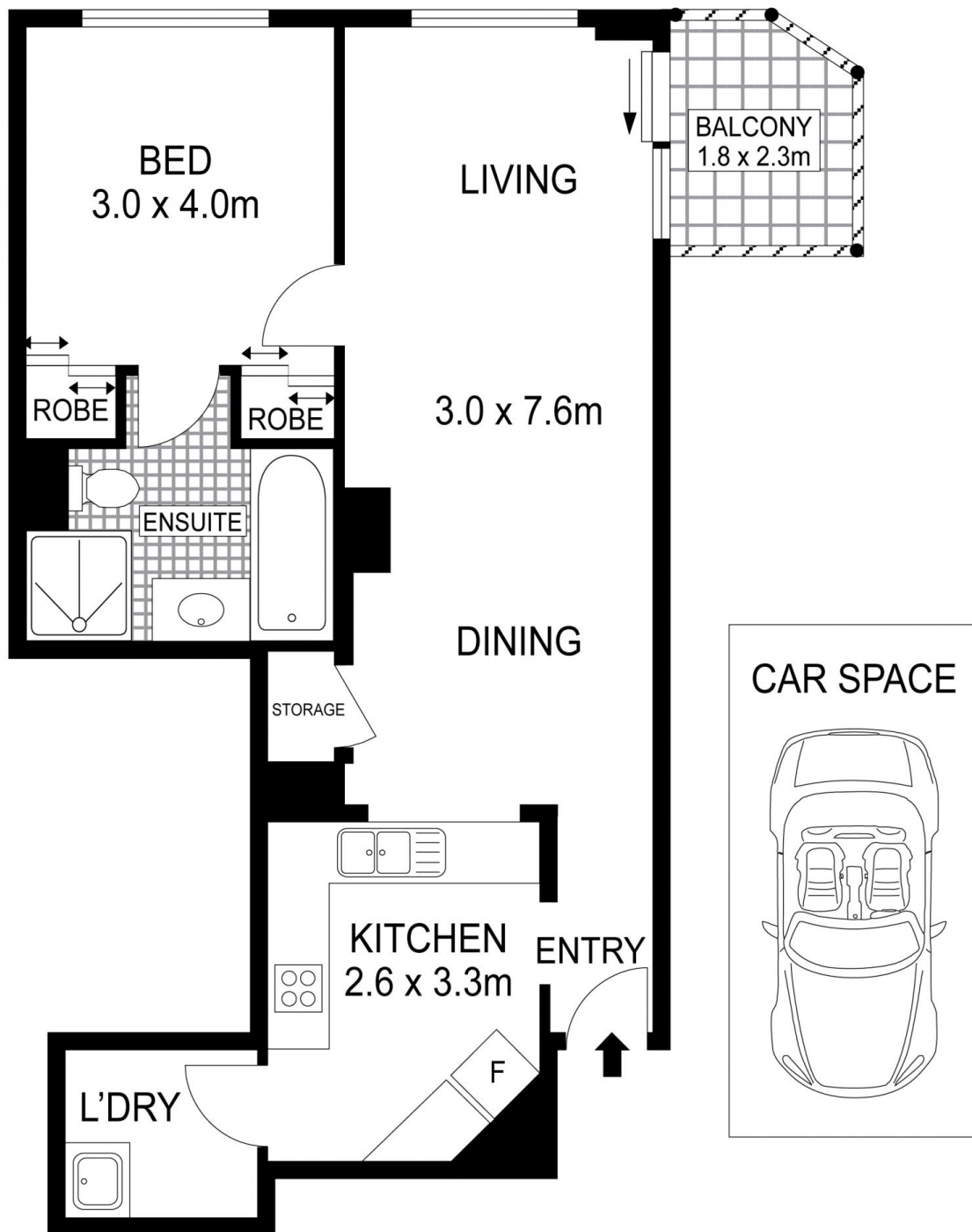

ELEVENTH LEVEL



Plans shown are for presentation purposes only and are not part of any legal document or title. They are subject to errors, omissions, inaccuracies and should not be used as a sole and accurate reference. Interested parties should make their own inquiries using independent sources.

76/25 Wentworth Avenue, Surry Hills