

# CITY LIVING

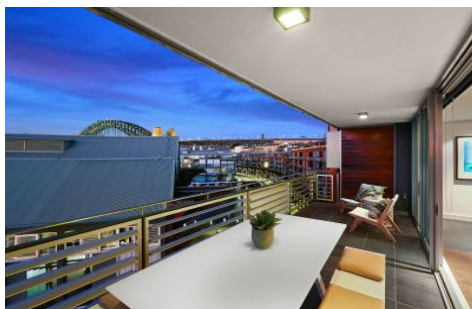

**601/21A Hickson Road SYDNEY NSW**

3 2 2

This apartment is perfectly situated to deliver one of the best views in Mirvac's foreshore development, with a picturesque vista from both the open plan living area and balcony that spans from Sydney's iconic harbour bridge to Barangaroo's newly developed Headland Park, while the majority of other apartments situated on the shore are only able to see Sydney's iconic bridge from their balcony.

The privacy - Located on level six of a seven storey development this apartment is perfectly situated to offer privacy to residents, but it does have adjustable louvres if you feel the need for a bit more

The balcony - Spanning the length of the open plan living area, the balcony is the ideal setting for afternoon drinks with friends or an evening barbecue with a stunning

**Type** : Apartment  
**Building Size** : 15 sqm  
**View** : <https://www.cityliving.com.au/sale/nsw/sydney-city/sydney/residential/apartment/7223367>



**Tasman Fallshaw**  
**02 8248 9104**

[For full version visit the website](https://www.cityliving.com.au)

<https://www.cityliving.com.au>

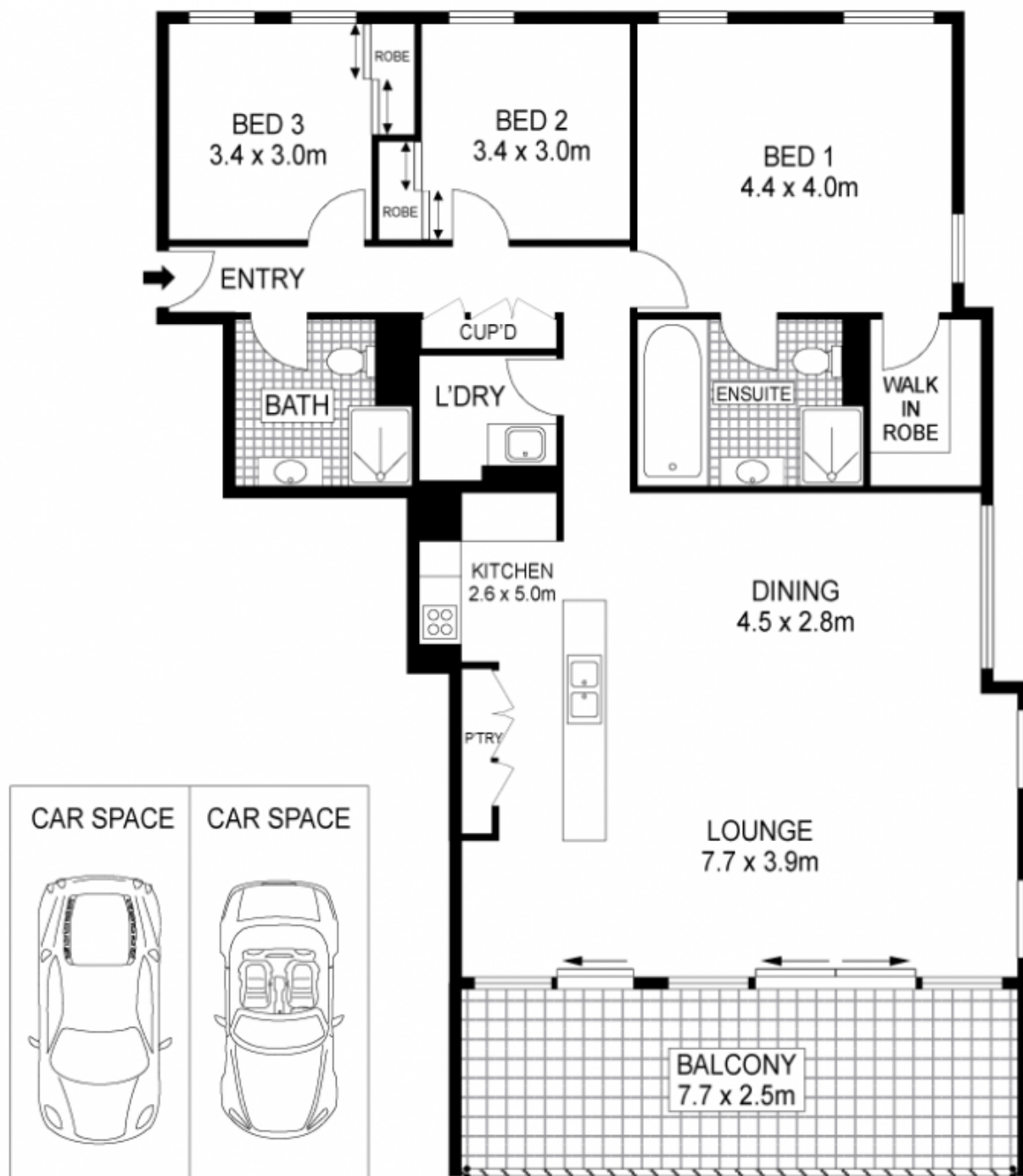

**LEVEL SIX**



Plans shown are for presentation purposes only and are not part of any legal document or title. They are subject to errors, omissions, inaccuracies and should not be used as a sole and accurate reference. Interested parties should make their own inquiries using independent sources.

601/21A Hickson Road, Walsh Bay